



LUMINAIRE TESTING LABORATORY, INC.

SUSTAINING
MEMBER
of the
IESNA

905 Harrison Street · Allentown, PA 18103 · 610-770-1044 · Fax 610-770-8912 · www.LuminaireTesting.com

LTL NUMBER: 13046

DATE: 04-21-2008

PREPARED FOR: PRECISION ARCHITECTURAL LIGHTING

CATALOG NUMBER: MLS-I2/D2-4-X-OP/LP-X-120-T5

LUMINAIRE: EXTRUDED ALUMINUM HOUSING, FORMED SPECULAR ALUMINUM UPPER REFLECTOR, FORMED WHITE ENAMEL ALUMINUM LOWER REFLECTOR, CLEAR LINEAR PRISMATIC PLASTIC LOWE LENS, OPEN TOP.

LAMPS: FOUR 28 WATT T5 LINEAR FLUORESCENT LAMPS RATED AT 2610 LUMENS EACH.

LAMP CATALOG NUMBER: PHILIPS F28T5/835/ALTO

BALLASTS: TWO ADVANCE ICN-2S28

MOUNTING: PENDANT

NOTE: THIS TEST WAS CALCULATED USING MEASURED DATA FROM LTL TEST NUMBERS 13036 AND 12722.
LUMEN TO CANDELA RATIO USED = 9.18
TOTAL INPUT WATTS =111.3 AT 120.0 VOLTS
THE 0 DEGREE PLANE IS PARALLEL WITH THE LAMPS.

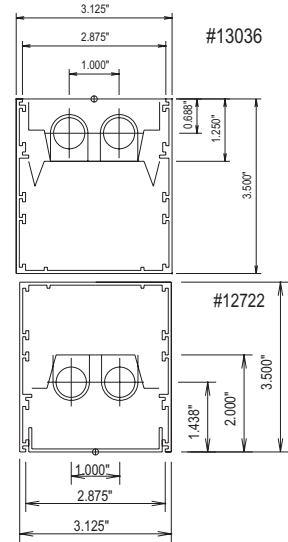

CANDELA DISTRIBUTION						FLUX
	0.0	22.5	45.0	67.5	90.0	
0	1137	1137	1137	1137	1137	
5	1131	1129	1133	1126	1129	107
15	1088	1081	1074	1060	1060	303
25	1003	987	964	922	907	440
35	874	844	762	694	678	480
45	699	631	538	492	478	433
55	473	401	333	283	265	311
65	222	216	171	146	140	179
75	78	94	93	88	85	94
85	13	27	32	30	29	30
90	0	2	4	6	6	
95	47	86	71	66	62	80
105	223	314	374	378	379	359
115	429	544	592	632	652	574
125	623	833	774	846	852	715
135	798	1068	1072	1000	985	778
145	947	1141	1281	1273	1271	751
155	1066	1142	1379	1434	1438	599
165	1149	1197	1242	1324	1362	357
175	1192	1191	1219	1228	1229	116
180	1188	1188	1188	1188	1188	

ZONAL LUMEN SUMMARY			
ZONE	LUMENS	%LAMP	%FIXT
0- 30	850	8.1	12.7
0- 40	1330	12.7	19.8
0- 60	2074	19.9	30.9
0- 90	2378	22.8	35.4
90-120	1013	9.7	15.1
90-130	1728	16.6	25.8
90-150	3257	31.2	48.6
90-180	4330	41.5	64.6
0-180	6707	64.2	100.0

TOTAL LUMINAIRE EFFICIENCY: 64.2%
CIE TYPE: SEMI-INDIRECT
PLANE: 0-DEG 90-DEG
SPACING CRITERIA: 1.2 1.1

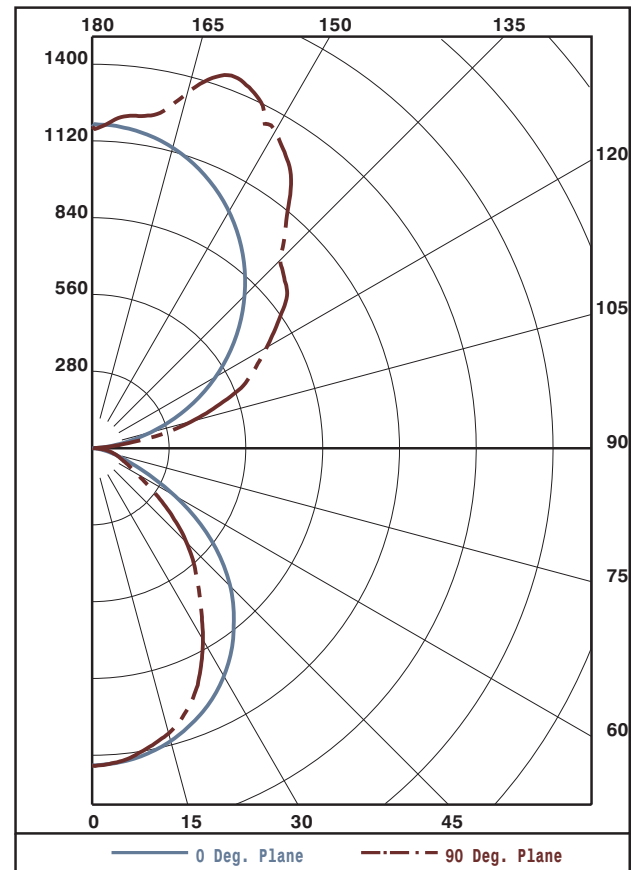

Approved By: MG



LUMINAIRE TESTING LABORATORY, INC.

SUSTAINING MEMBER of the IESNA

905 Harrison Street · Allentown, PA 18103 · 610-770-1044 · Fax 610-770-8912 · www.LuminaireTesting.com

LTL NUMBER: 13046

DATE: 04-21-2008

PREPARED FOR: PRECISION ARCHITECTURAL LIGHTING

COEFFICIENTS OF UTILIZATION - ZONAL CAVITY METHOD
EFFECTIVE FLOOR CAVITY REFLECTANCE 0.20

Table with columns RC, RW, and rows for angles 0-10 and reflectance values 80, 70, 50, 30, 10. Values range from 0 to 23.

PLANE: 0-DEG 90-DEG
LUMINOUS LENGTH: 48.000 2.875

Table with columns ANGLE IN DEG, AVERAGE 0-DEG, AVERAGE 45-DEG, AVERAGE 90-DEG. Values range from 12770 to 1675.



LUMINAIRE TESTING LABORATORY, INC.

SUSTAINING MEMBER of the IESNA

905 Harrison Street · Allentown, PA 18103 · 610-770-1044 · Fax 610-770-8912 · www.LuminaireTesting.com

LTL NUMBER: 13046
PREPARED FOR: PRECISION ARCHITECTURAL LIGHTING

DATE: 04-21-2008

CANDELA DISTRIBUTION

ZONAL LUMEN SUMMARY

Table with 6 columns for Candela Distribution (0.0 to 180) and 3 columns for Zonal Lumen Summary (0-5 to 175-180).

THIS TEST WAS CONDUCTED USING RELATIVE PHOTOMETRY TECHNIQUES ACCORDING TO STANDARD IESNA PROCEDURES. THE USER MUST THEREFORE USE CAUTION IN THE FOLLOWING SITUATIONS: 1) THIS TEST WAS PERFORMED USING A SPECIFIC BALLAST/LAMP COMBINATION. EXTRAPOLATION OF THESE DATA FOR OTHER BALLAST/LAMP COMBINATIONS MAY PRODUCE ERRONEOUS RESULTS. 2) ACCORDING TO IESNA PROCEDURES, THE BALLAST(S) AND LAMP(S) ARE PRESUMED TO PRODUCE 100% OF RATED OUTPUT. AN APPROPRIATE BALLAST FACTOR MUST BE APPLIED TO THE LUMEN OUTPUT RATINGS AND LUMINOUS INTENSITY VALUES GIVEN. 3) THIS TEST WAS CONDUCTED IN A CONTROLLED LABORATORY ENVIRONMENT WHERE THE AMBIENT TEMPERATURE WAS HELD AT 25°C ±1°C. FIELD PERFORMANCE MAY DIFFER PARTICULARLY IN REGARDS TO CHANGE IN LUMINOUS OUTPUT AS A RESULT OF DIFFERENCE IN AMBIENT TEMPERATURE AND METHOD OF MOUNTING THE LUMINAIRE.