

Microlinea™ Wall Series 2 - LED



Catalog Number	Type
Project Name	

MLP2-IASY/D-LED

2 1/4" x 4 1/2" Indirect/Direct

ADA Compliant



S P E C I F I C A T I O N S

Housing

One-piece .070" thick extruded aluminum. Die-cast aluminum end caps are secured with no visible fasteners. Standard lengths are nominal 2', 3', 4', 6', 8' and 12'. Provisions may be made for continuous rows of any length.

Finish

Standard and premium finishes are baked powder coat electrostatically applied (2.0 mil minimum thickness) to assure aesthetics and durability.

Indirect Optical Controls

- (OP) Open
- (DC) Frosted extruded 100% DR acrylic dust cover

Direct Optical Controls

(LOH) Clear co-extruded 100% DR acrylic lens with high transmittance diffusing insert.

Reflector/Heat Sink

- Indirect - .060" thick die-formed aluminum finished with a high reflectance white enamel.
- Direct - .060" thick die-formed aluminum finished with a high reflectance white enamel.

Driver

Osram-Sylvania "Optotronic" power supply is UL/CUL recognized, 0-10V dimming available, 120-277 universal voltage.

Light Engine

Osram-Sylvania LED modules available for 3000K, 3500K and 4000K CCT:

- MO/MO:** *4495 Total Delivered Lms. at 49 System Watts
 - MO/HO:** *5419 Total Delivered Lms. at 65 System Watts
 - HO/MO:** *5883 Total Delivered Lms. at 66 System Watts
 - HO/HO:** *6777 Total Delivered Lms. at 81 System Watts
- (*Values per 4' length using 3500K LED modules)

*Due to continued advancement in LED technology, lumen performance is subject to change. Please visit our website for the most up-to-date information.

Circuitry

All fixtures are factory pre-wired for a single circuit. Provision for multiple switching/circuiting is optional.

Wiring

All fixtures intended for continuous rows are provided with factory installed quick-connect wiring.

Controls

Contact factory for control by Occupancy Sensors, Photo Controls and Daylight Harvesting.

Certification

All fixtures are UL/CUL listed for use in 'Dry Applications'. 'Damp Location' is optional.

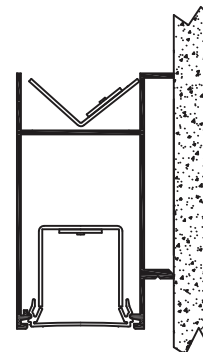

MLP2-IASY/D-MO/MO
MLP2-IASY/D-MO/HO
MLP2-IASY/D-HO/MO
MLP2-IASY/D-HO/HO

Standard Lengths:

2', 3', 4', 6', 8' and 12'
For continuous rows of 12' or longer, specify nominal row length in 1' increments.

See Microlinea Row Guide section.

Mounting
W = Wall

Voltage
120
277

Series
MLP2-IASY/D

CCT
K30
3000 Kelvin
K35
3500 Kelvin
K40
4000 Kelvin

MLP2-IASY/D-HO/HO-K35-12-W-DC/LOH-F01M-V-[]

Lumen Outputs - Indirect & Direct

- MO/MO** -(Med. Output Up/Med. Output Dn.)
*4495 Total Lumens/4' - 90 Lm/W
- MO/HO** -(Med. Output Up/High Output Dn.)
*5419 Total Lumens/4' - 83 Lm/W
- HO/MO** -(High Output Up/Med. Output Dn.)
*5883 Total Lumens/4' - 89 Lm/W
- HO/HO** -(High Output Up/High Output Dn.)
*6777 Total Lumens/4' - 81 Lm/W

*Lumen ratings per 4' section at 3500K.

Indirect Optical Controls

- OP**
Open
- DC**
Frosted Dust Cover

Direct Optical Controls

- LOH**
LED Optimized High Transmittance Lens

Standard Finishes

- F01M** Matte White
- Premium Finishes**
- F01G** Gloss White
- F02** Ivory
- F03** Stonewash
- F04** Camel
- F05** Gray Day
- F06** Pebble Beach
- F07** Steel
- F08** Gray Seal
- F09** Mocha
- F10** Bronzed
- F11G** Gloss Black
- F11M** Matte Black
- F12** Ultrasonic Clear
- F13** Merlot
- F14** Red Skies
- F15** Lemon
- F16** Forest Hunter
- F17** Olive
- F18** Khaki
- F19** Heather Green
- F20** Blue Print
- F21** Reflex Blue
- F22** Navy
- FCC** Custom Color

Options

- SS(U/L)**(Upper/Lower) LED Row Switching (Common Neutral)
- NLCKT** Night Light Circuit (Common Neutral)
- EMCKT** Emergency Circuit (Separate Hot & Neutral)
- EBPL** Emergency Battery Pack (Contact Factory)

Dim

- Dimming
- FS** Fused Drivers
- GTD** Generator Transfer Device
- DL** Damp Location



Precision Architectural Lighting 4830 Timber Creek Drive Houston, Texas 77017
Tel 713.946.4343 Fax 713.946.4441 www.pal-lighting.com



Made in America

Wall

MLP2-I/D-HO/HO-K35-OP/LOH

High Output Up/High Output Down

LED Optimized High Transmittance Lens

Catalog Number: MLP2-I/D-HO/HO-K35-4'-W-OP/LOH-120

Report Number: ITL#80651.ies

Luminaire Description: Extruded Aluminum Housing with White Aluminum Reflector and LED Optimized Acrylic Lens with Insert

LED Module: Multiple White Low-Power Light Emitting Diodes (LEDs) in a precise lay-out.

Total Luminaire Efficacy = 83.2 Lm/W

Color Rendering Index (CRI) = 82

60% Up 40% Down

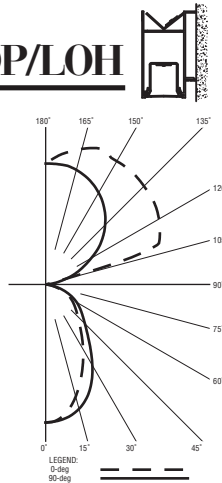

lighting facts®	
A Program of the U.S. DOE	
Light Output (Lumens)	6777
Watts	81.5
Lumens per Watt (Efficacy)	83
Color Accuracy	82
Color Rendering Index (CRI)	
Light Color	3507 (Bright White)
Correlated Color Temperature (CCT)	
Warm White	Bright White
2700K	3000K
4500K	6500K
All results are according to IESNA LM-79-2008: Approved Method for the Electrical and Photometric Testing of Solid-State Lighting. The U.S. Department of Energy (DOE) verifies product test data and results.	
Visit www.lightingfacts.com for the Label Reference Guide.	
Registration Number: 1NRP-NGVX2T (3/27/2014)	
Model Number: MLP2-I/D-HO/HO-K35-4'-W-OP/LOH-120	
Type: Luminaire - Linear	

MLP2-I/D-MO/HO-K35-OP/LOH

Medium Output Up/High Output Down

LED Optimized High Transmittance Lens

Catalog Number: MLP2-I/D-MO/HO-K35-4'-W-OP/LOH-120

Report Number: ITL#80654.ies

Luminaire Description: Extruded Aluminum Housing with White Aluminum Reflector and LED Optimized Acrylic Lens with Insert

LED Module: Multiple White Low-Power Light Emitting Diodes (LEDs) in a precise lay-out.

Total Luminaire Efficacy = 83.1 Lm/W

Color Rendering Index (CRI) = 82

49% Up 51% Down

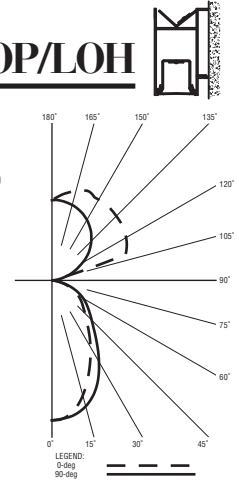

lighting facts®	
A Program of the U.S. DOE	
Light Output (Lumens)	5419
Watts	65.2
Lumens per Watt (Efficacy)	83
Color Accuracy	82
Color Rendering Index (CRI)	
Light Color	3505 (Bright White)
Correlated Color Temperature (CCT)	
Warm White	Bright White
2700K	3000K
4500K	6500K
All results are according to IESNA LM-79-2008: Approved Method for the Electrical and Photometric Testing of Solid-State Lighting. The U.S. Department of Energy (DOE) verifies product test data and results.	
Visit www.lightingfacts.com for the Label Reference Guide.	
Registration Number: 1NRP-DOE4HG (3/27/2014)	
Model Number: MLP2-I/D-MO/HO-K35-4'-W-OP/LOH-120	
Type: Luminaire - Linear	

MLP2-I/D-HO/MO-K35-OP/LOH

High Output Up/Medium Output Down

LED Optimized High Transmittance Lens

Catalog Number: MLP2-I/D-HO/MO-K35-4'-W-OP/LOH-120

Report Number: ITL#80652.ies

Luminaire Description: Extruded Aluminum Housing with White Aluminum Reflector and LED Optimized Acrylic Lens with Insert

LED Module: Multiple White Low-Power Light Emitting Diodes (LEDs) in a precise lay-out.

Total Luminaire Efficacy = 89.3 Lm/W

Color Rendering Index (CRI) = 82

69% Up 31% Down

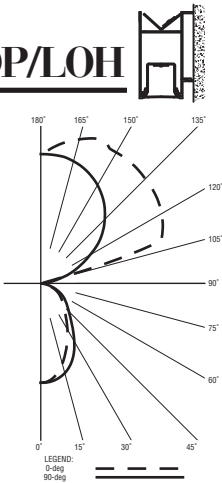

lighting facts®	
A Program of the U.S. DOE	
Light Output (Lumens)	5883
Watts	65.9
Lumens per Watt (Efficacy)	89
Color Accuracy	82
Color Rendering Index (CRI)	
Light Color	3507 (Bright White)
Correlated Color Temperature (CCT)	
Warm White	Bright White
2700K	3000K
4500K	6500K
All results are according to IESNA LM-79-2008: Approved Method for the Electrical and Photometric Testing of Solid-State Lighting. The U.S. Department of Energy (DOE) verifies product test data and results.	
Visit www.lightingfacts.com for the Label Reference Guide.	
Registration Number: 1NRP-SE8SL (3/27/2014)	
Model Number: MLP2-I/D-HO/MO-K35-4'-W-OP/LOH-120	
Type: Luminaire - Linear	

MLP2-I/D-MO/MO-K35-OP/LOH

Medium Output Up/Medium Output Down

LED Optimized High Transmittance Lens

Catalog Number: MLP2-I/D-MO/MO-K35-4'-W-OP/LOH-120

Report Number: ITL#80653.ies

Luminaire Description: Extruded Aluminum Housing with White Aluminum Reflector and LED Optimized Acrylic Lens with Insert

LED Module: Multiple White Low-Power Light Emitting Diodes (LEDs) in a precise lay-out.

Total Luminaire Efficacy = 90.8 Lm/W

Color Rendering Index (CRI) = 82

59% Up 41% Down

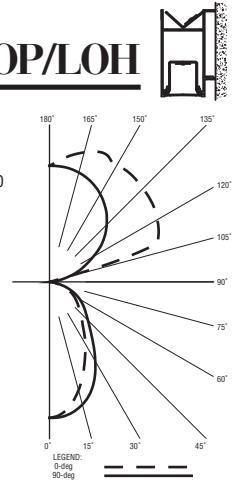

lighting facts®	
A Program of the U.S. DOE	
Light Output (Lumens)	4495
Watts	49.5
Lumens per Watt (Efficacy)	90
Color Accuracy	82
Color Rendering Index (CRI)	
Light Color	3499 (Bright White)
Correlated Color Temperature (CCT)	
Warm White	Bright White
2700K	3000K
4500K	6500K
All results are according to IESNA LM-79-2008: Approved Method for the Electrical and Photometric Testing of Solid-State Lighting. The U.S. Department of Energy (DOE) verifies product test data and results.	
Visit www.lightingfacts.com for the Label Reference Guide.	
Registration Number: 1NRP-P8T2HL (3/27/2014)	
Model Number: MLP2-I/D-MO/MO-K35-4'-W-OP/LOH-120	
Type: Luminaire - Linear	

For more information, visit our website at www.pal-lighting.com



Precision Architectural Lighting 4830 Timber Creek Drive Houston, Texas 77017
Tel 713.946.4343 Fax 713.946.4441 www.pal-lighting.com



Made in America