

Microlinea™ Wall Series 2 - LED



Catalog Number	Type
Project Name	

MLP2-IASY/D-LED

2 1/4" x 4 1/2" Indirect/Direct

ADA Compliant



S P E C I F I C A T I O N S

Housing

One-piece .070" thick extruded aluminum. Die-cast aluminum end caps are secured with no visible fasteners. Standard lengths are nominal 2', 3', 4', 6', 8' and 12'. Provisions may be made for continuous rows of any length.

Finish

Standard and premium finishes are baked powder coat electrostatically applied (2.0 mil minimum thickness) to assure aesthetics and durability.

Indirect Optical Controls

- (OP) Open
- (FDC) Frosted 100% Polycarbonate Dust Cover

Direct Optical Controls

(LOH) .070" thick, high transmittance extruded acrylic snap-in lens, formulated for maximum diffusion of the LED light source.

Reflector/Heat Sink

- Indirect - .040" thick die-formed aluminum finished with a high reflectance white enamel.
- Direct - .040" thick die-formed aluminum finished with a high reflectance white enamel.

Driver

Osram-Sylvania "Optotronic" power supply is UL/CUL recognized, 0-10V dimming available, 120-277 universal voltage.

Light Engine

Osram-Sylvania LED modules available for 3000K, 3500K and 4000K CCT:

MO/MO: *4495 Total Delivered Lms. at 49 System Watts
MO/HO: *5419 Total Delivered Lms. at 65 System Watts
HO/MO: *5883 Total Delivered Lms. at 66 System Watts
HO/HO: *6777 Total Delivered Lms. at 81 System Watts
(*Values per 4' length using 3500K LED modules)

*Due to continued advancement in LED technology, lumen performance is subject to change. Please visit our website for the most up-to-date information.

Circuitry

All fixtures are factory pre-wired for a single circuit. Provision for multiple switching/circuiting is optional.

Wiring

All fixtures intended for continuous rows are provided with factory installed quick-connect wiring.

Controls

Contact factory for control by Occupancy Sensors, Photo Controls and Daylight Harvesting.

Certification

All fixtures are UL/CUL listed for use in 'Dry Applications'. 'Damp Location' is optional.

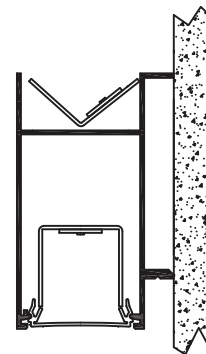

MLP2-IASY/D-MO/MO

MLP2-IASY/D-MO/HO

MLP2-IASY/D-HO/MO

MLP2-IASY/D-HO/HO

Series

MLP2-IASY/D

CCT

K30
3000 Kelvin
K35
3500 Kelvin
K40
4000 Kelvin

Standard Lengths:

2', 3', 4', 6', 8' and 12'

For continuous rows of 12' or longer, specify nominal row length in 1' increments.

Mounting

W = Wall

Voltage

120
277
347
UNV

MLP2-IASY/D-HO/HO-K35-80-12-W-OP/LOH-F01M-V-[]

Lumen Outputs - Indirect & Direct

MO/MO -(Med. Output Up/Med. Output Dn.)

*4495 Total Lumens/4' - 90 Lm/W

MO/HO -(Med. Output Up/High Output Dn.)

*5419 Total Lumens/4' - 83 Lm/W

HO/MO -(High Output Up/Med. Output Dn.)

*5883 Total Lumens/4' - 89 Lm/W

HO/HO -(High Output Up/High Output Dn.)

*6777 Total Lumens/4' - 81 Lm/W

*Lumen ratings per 4' section at 3500K.

CRI

80
90

Indirect Optical Controls

OP
Open
FDC
Frosted Dust Cover

Direct Optical Controls

LOH
LED Optimized High Transmittance Lens

Standard Finishes

F01M Matte White

Premium Finishes

F01G Gloss White
F02 Ivory
F03 Stonewash
F04 Camel
F05 Gray Day
F06 Pebble Beach
F07 Steel
F08 Gray Seal
F09 Mocha
F10 Bronzed
F11G Gloss Black
F11M Matte Black
F12 Ultrasonic Clear
F13 Merlot
F14 Red Skies
F15 Lemon
F16 Forest Hunter
F20 Blue Print
F21 Reflex Blue
F22 Navy
FCC Custom Color

Options

SS(U/L) (Upper/Lower) LED Row Switching (Common Neutral)

NLCKT Night Light Circuit (Common Neutral)

EMCKT Emergency Circuit (Separate Hot & Neutral)

EBPL Emergency Battery Pack (6 Watt) *N/A for 2' & 3'

EBPH Emergency Battery Pack (10 Watt) *N/A for 2' & 3'

Dim10

Dimming - to 10%

Dim1

Dimming - to 1%

Dim

Dimming - to 0% (Dark)

FS

Fused Drivers

GTD

Generator Transfer Device

DL

Damp Location



Precision Architectural Lighting 4830 Timber Creek Drive Houston, Texas 77017

Tel 713.946.4343 Fax 713.946.4441 www.pal-lighting.com



Made in America

Wall

MLP2-I/D-HO/HO-K35-OP/LOH

High Output Up/High Output Down

LED Optimized High Transmittance Lens

Catalog Number: MLP2-I/D-HO/HO-K35-4'-W-OP/LOH-120

Report Number: ITL#80651.ies

Luminaire Description: Extruded Aluminum Housing with White Aluminum Reflector and LED Optimized Acrylic Lens with Insert

LED Module: Multiple White Low-Power Light Emitting Diodes (LEDs) in a precise lay-out.

Total Luminaire Efficacy = 83.2 Lm/W

Color Rendering Index (CRI) = 82

60% Up 40% Down

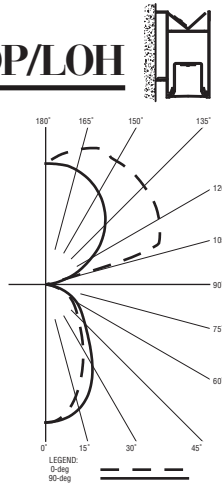

PRECISION ARCHITECTURAL LIGHTING	
lighting facts®	
A Program of the U.S. DOE	
Light Output (Lumens)	6777
Watts	81.5
Lumens per Watt (Efficacy)	83
Color Accuracy	82
Color Rendering Index (CRI)	
Light Color	3507 (Bright White)
Correlated Color Temperature (CCT)	
Warm White	Bright White
2700K	3000K
4500K	6500K
Daylight	
All results are according to IESNA LM-79-2008: Approved Method for the Electrical and Photometric Testing of Solid-State Lighting. The U.S. Department of Energy (DOE) verifies product test data and results.	
Visit www.lightingfacts.com for the Label Reference Guide.	
Registration Number: 1NRP-NDW27 (3/27/2014)	
Model Number: MLP2-IASVD-HO-HO-K35-4-OP/LOH-120	
Type: Luminaire - Linear	

MLP2-I/D-MO/HO-K35-OP/LOH

Medium Output Up/High Output Down

LED Optimized High Transmittance Lens

Catalog Number: MLP2-I/D-MO/HO-K35-4'-W-OP/LOH-120

Report Number: ITL#80654.ies

Luminaire Description: Extruded Aluminum Housing with White Aluminum Reflector and LED Optimized Acrylic Lens with Insert

LED Module: Multiple White Low-Power Light Emitting Diodes (LEDs) in a precise lay-out.

Total Luminaire Efficacy = 83.1 Lm/W

Color Rendering Index (CRI) = 82

49% Up 51% Down

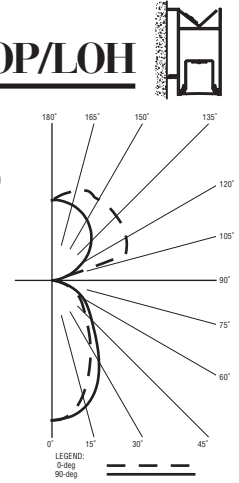

PRECISION ARCHITECTURAL LIGHTING	
lighting facts®	
A Program of the U.S. DOE	
Light Output (Lumens)	5419
Watts	65.2
Lumens per Watt (Efficacy)	83
Color Accuracy	82
Color Rendering Index (CRI)	
Light Color	3505 (Bright White)
Correlated Color Temperature (CCT)	
Warm White	Bright White
2700K	3000K
4500K	6500K
Daylight	
All results are according to IESNA LM-79-2008: Approved Method for the Electrical and Photometric Testing of Solid-State Lighting. The U.S. Department of Energy (DOE) verifies product test data and results.	
Visit www.lightingfacts.com for the Label Reference Guide.	
Registration Number: 1NRP-DOE116 (3/27/2014)	
Model Number: MLP2-IASVD-MO-HO-K35-4-OP/LOH-120	
Type: Luminaire - Linear	

MLP2-I/D-HO/MO-K35-OP/LOH

High Output Up/Medium Output Down

LED Optimized High Transmittance Lens

Catalog Number: MLP2-I/D-HO/MO-K35-4'-W-OP/LOH-120

Report Number: ITL#80652.ies

Luminaire Description: Extruded Aluminum Housing with White Aluminum Reflector and LED Optimized Acrylic Lens with Insert

LED Module: Multiple White Low-Power Light Emitting Diodes (LEDs) in a precise lay-out.

Total Luminaire Efficacy = 89.3 Lm/W

Color Rendering Index (CRI) = 82

69% Up 31% Down

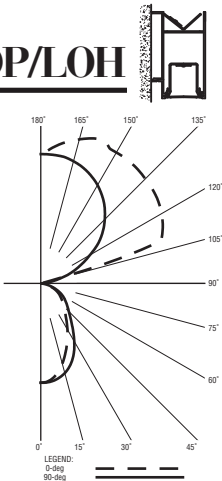

PRECISION ARCHITECTURAL LIGHTING	
lighting facts®	
A Program of the U.S. DOE	
Light Output (Lumens)	5883
Watts	65.9
Lumens per Watt (Efficacy)	89
Color Accuracy	82
Color Rendering Index (CRI)	
Light Color	3507 (Bright White)
Correlated Color Temperature (CCT)	
Warm White	Bright White
2700K	3000K
4500K	6500K
Daylight	
All results are according to IESNA LM-79-2008: Approved Method for the Electrical and Photometric Testing of Solid-State Lighting. The U.S. Department of Energy (DOE) verifies product test data and results.	
Visit www.lightingfacts.com for the Label Reference Guide.	
Registration Number: 1NRP-RES16 (3/27/2014)	
Model Number: MLP2-IASVD-HO-MO-K35-4-OP/LOH-120	
Type: Luminaire - Linear	

MLP2-I/D-MO/MO-K35-OP/LOH

Medium Output Up/Medium Output Down

LED Optimized High Transmittance Lens

Catalog Number: MLP2-I/D-MO/MO-K35-4'-W-OP/LOH-120

Report Number: ITL#80653.ies

Luminaire Description: Extruded Aluminum Housing with White Aluminum Reflector and LED Optimized Acrylic Lens with Insert

LED Module: Multiple White Low-Power Light Emitting Diodes (LEDs) in a precise lay-out.

Total Luminaire Efficacy = 90.8 Lm/W

Color Rendering Index (CRI) = 82

59% Up 41% Down

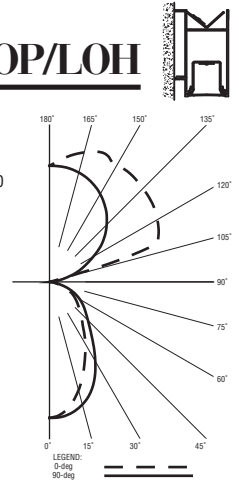

PRECISION ARCHITECTURAL LIGHTING	
lighting facts®	
A Program of the U.S. DOE	
Light Output (Lumens)	4495
Watts	49.5
Lumens per Watt (Efficacy)	90
Color Accuracy	82
Color Rendering Index (CRI)	
Light Color	3499 (Bright White)
Correlated Color Temperature (CCT)	
Warm White	Bright White
2700K	3000K
4500K	6500K
Daylight	
All results are according to IESNA LM-79-2008: Approved Method for the Electrical and Photometric Testing of Solid-State Lighting. The U.S. Department of Energy (DOE) verifies product test data and results.	
Visit www.lightingfacts.com for the Label Reference Guide.	
Registration Number: 1NRP-PBT24 (3/27/2014)	
Model Number: MLP2-IASVD-MO-MO-K35-4-OP/LOH-120	
Type: Luminaire - Linear	



Precision Architectural Lighting 4830 Timber Creek Drive Houston, Texas 77017
Tel 713.946.4343 Fax 713.946.4441 www.pal-lighting.com

For more information, visit our website at www.pal-lighting.com



Made in America