

# Microlinea™ Recessed Series 3 - Fluorescent (2 7/8" Luminous Aperture)

Catalog Number	Type
Project Name	

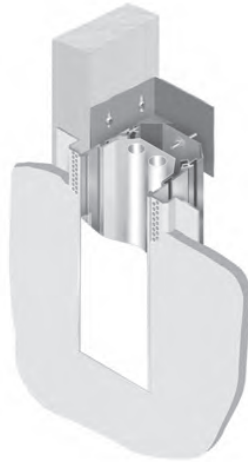

Vertical Drywall  
Overlap Flange



Vertical Drywall  
Spackle Flange

## Vertical Wall Mount 1/2" or 5/8" Thick Drywall

(1 or 2 - T5 or T5HO Lamps)

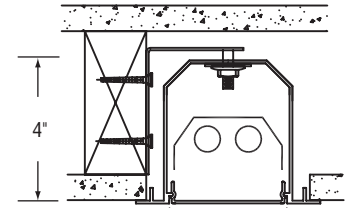

MLR3-2-VOF  
Vertical Drywall  
Overlap Flange  
Shown with Flush Lens

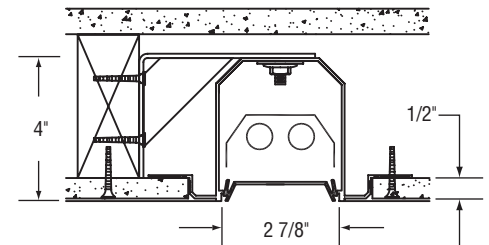

MLR3-2-VSF1  
Vertical Drywall  
Spackle Flange  
Shown with Regress Lens

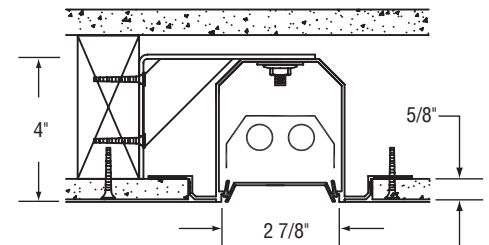

MLR3-2-VSF5  
Vertical Drywall  
Spackle Flange  
Shown with Regress Lens

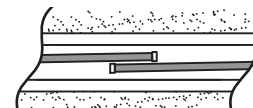

Staggered Lamping - 1 Lp

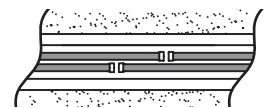

Staggered Lamping - 2 Lp

### S P E C I F I C A T I O N S

#### Housing

Three piece extruded aluminum available in single sections up to 8' long. Standard flange finish is satin white.

#### Optical Controls

- (LP) Flush clear extruded DR acrylic linear prismatic lens
- (TWA) Flush translucent white extruded DR acrylic lens
- (FC) Flush frosted clear extruded DR acrylic lens
- (RTWA) Regressed translucent white DR acrylic lens

#### Staggered Lamping

Staggered lamping is standard for all continuous rows. See Microlinea Row Guide Section.

#### Reflectors

Die-formed from .020" thick aluminum and finished with a high reflectance white enamel.

#### Ballast

Standard ballasts for T5 and T5HO lamps are UL/CUL listed, Class P, HPF, electronic, universal 120/277volt, programmed rapid start with <10% THD.

#### Circuitry

All fixtures are factory pre-wired for a single circuit. Provision for multiple switching/circuiting is optional.

#### Wiring

All fixtures intended for continuous rows are provided with factory installed quick-connect wiring.

#### Certification

All fixtures are UL/CUL listed for use in 'Dry Applications'. 'Damp Location' is optional.

**Series**  
MLR3

**Nominal Length:**  
See Microlinea Row Guide Section for 1 lamp and 2 lamp lengths.

**Mountings**  
VOF = Vertical Wall Mount Overlap Flange  
VSF5 = Vertical Wall Mount Spackle Flange w/5/8" Drywall  
VSF1 = Vertical Wall Mount Spackle Flange w/1/2" Drywall

## MLR3-1-10'-VOF-TWA-120-T5-[ ]

**# of Lamps in Cross-Section**  
1  
2

**Optical Controls**  
LP  
Linear Prismatic Lens  
**TWA**  
Translucent White Acrylic Lens  
**FC**  
Frosted Clear Lens  
**RTWA**  
Regressed Translucent White Acrylic Lens

**Voltage**  
120  
277  
347

**Lamp Type**  
T5  
T5HO

**Options**  
**SS(L/R)** (Left/Right)  
Lamp Row Switching (Common Neutral) (N/A for 2' or 3')  
**NLCKT**  
Night Light Circuit (Common Neutral) (N/A for 2' or 3')  
**EMCKT**  
Emergency Circuit (Separate Hot & Neutral) (N/A for 2' or 3')  
**EBPL**  
Emergency Battery Pack (635-700 Lumens) (N/A for 2' or 3')

**EBPH**  
Emergency Battery Pack (975-1325 Lumens) (N/A for 2' or 3')  
**Dim**  
Dimming  
**FS**  
Fused Ballasts  
**GTD**  
Generator Transfer Device (N/A for 2' or 3')  
**DL**  
Damp Location



# Recessed

## MLR3-1-PB-T5



### Semi-Specular Aluminum Parabolic Baffle

**Catalog Number:** MLR3-1-4'-X-PB-120-T5

**Report Number:** LTL#18434.ies

**Luminaire Description:** Extruded Aluminum Housing with White Aluminum Reflector and Semi-Specular Parabolic Baffle

**Lamp:** One Philips F28T5/841  
Rated at 2610 Lumens

Total Luminaire Efficiency = 59.3%

0% Up 100% Down

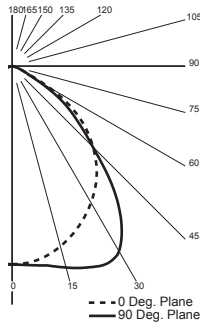

## MLR3-2-PB-T5



### Semi-Specular Aluminum Parabolic Baffle

**Catalog Number:** MLR3-2-4'-X-PB-120-T5

**Report Number:** LTL#18439.ies

**Luminaire Description:** Extruded Aluminum Housing with White Aluminum Reflector and Semi-Specular Parabolic Baffle

**Lamp:** Two Philips F28T5/841  
Rated at 2610 Lumens Each

Total Luminaire Efficiency = 47.9%

0% Up 100% Down

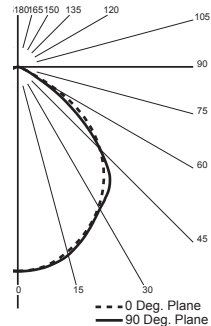

## MLR3-1-PBW-T5



### White Aluminum Parabolic Baffle

**Catalog Number:** MLR3-1-4'-X-PBW-120-T5

**Report Number:** LTL#18435.ies

**Luminaire Description:** Extruded Aluminum Housing with White Aluminum Reflector and White Parabolic Baffle

**Lamp:** One Philips F28T5/841  
Rated at 2610 Lumens

Total Luminaire Efficiency = 62.7%

0% Up 100% Down

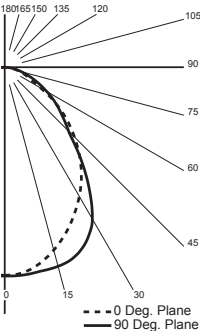

## MLR3-2-PBW-T5



### White Aluminum Parabolic Baffle

**Catalog Number:** MLR3-2-4'-X-PBW-120-T5

**Report Number:** LTL#18440.ies

**Luminaire Description:** Extruded Aluminum Housing with White Aluminum Reflector and White Parabolic Baffle

**Lamp:** Two Philips F28T5/841  
Rated at 2610 Lumens Each

Total Luminaire Efficiency = 49.9%

0% Up 100% Down

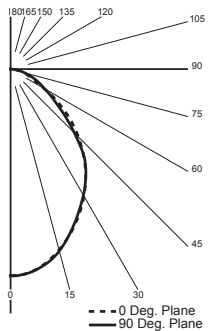

## MLR3-1-LP-T5



### Linear Prismatic Acrylic Lens

**Catalog Number:** MLR3-1-4'-X-LP-120-T5

**Report Number:** LTL#18436.ies

**Luminaire Description:** Extruded Aluminum Housing with White Aluminum Reflector and Linear Prismatic Acrylic Lens

**Lamp:** One Philips F28T5/841  
Rated at 2610 Lumens

Total Luminaire Efficiency = 69.0%

0% Up 100% Down

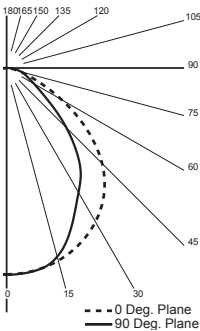

## MLR3-2-LP-T5



### Linear Prismatic Acrylic Lens

**Catalog Number:** MLR3-2-4'-X-LP-120-T5

**Report Number:** LTL#18441.ies

**Luminaire Description:** Extruded Aluminum Housing with White Aluminum Reflector and Linear Prismatic Acrylic Lens

**Lamp:** Two Philips F28T5/841  
Rated at 2610 Lumens Each

Total Luminaire Efficiency = 55.4%

0% Up 100% Down

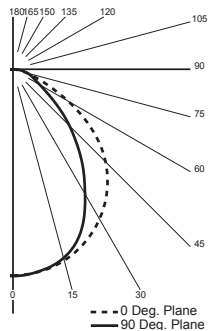

## MLR3-1-TWA-T5



### Translucent White Acrylic Lens

**Catalog Number:** MLR3-1-4'-X-TWA-120-T5

**Report Number:** LTL#18437.ies

**Luminaire Description:** Extruded Aluminum Housing with White Aluminum Reflector and Translucent White Acrylic Lens

**Lamp:** One Philips F28T5/841  
Rated at 2610 Lumens

Total Luminaire Efficiency = 57.6%

0% Up 100% Down

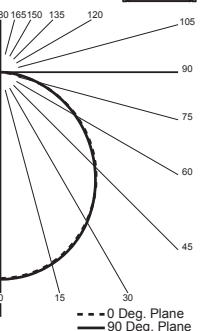

## MLR3-2-TWA-T5



### Translucent White Acrylic Lens

**Catalog Number:** MLR3-2-4'-X-TWA-120-T5

**Report Number:** LTL#18442.ies

**Luminaire Description:** Extruded Aluminum Housing with White Aluminum Reflector and Translucent White Acrylic Lens

**Lamp:** Two Philips F28T5/841  
Rated at 2610 Lumens Each

Total Luminaire Efficiency = 45.2%

0% Up 100% Down

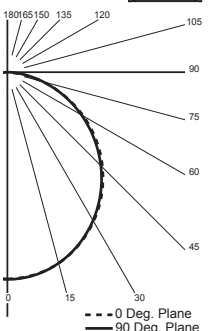

For more information, visit our website at [www.pal-lighting.com](http://www.pal-lighting.com)



Precision Architectural Lighting 4830 Timber Creek Drive Houston, Texas 77017  
Tel 713.946.4343 Fax 713.946.4441 [www.pal-lighting.com](http://www.pal-lighting.com)



Made in America