



LUMINAIRE TESTING LABORATORY, INC.

SUSTAINING MEMBER
of the
IESNA

905 Harrison Street · Allentown, PA 18103 · 610-770-1044 · Fax 610-770-8912 · www.LuminaireTesting.com

LTL NUMBER: 13043

DATE: 04-11-2008

PREPARED FOR: PRECISION ARCHITECTURAL LIGHTING

CATALOG NUMBER: MLS-I1/D2-4-X-OP/LP-X-120-T5

LUMINAIRE: EXTRUDED ALUMINUM HOUSING, FORMED SPECULAR ALUMINUM UPPER REFLECTOR, FORMED WHITE ENAMEL ALUMINUM LOWER REFLECTOR, CLEAR LINEAR PRISMATIC PLASTIC LOWER LENS, OPEN TOP.

LAMPS: THREE 28 WATT T5 LINEAR FLUORESCENT LAMPS RATED AT 2610 LUMENS EACH.

LAMP CATALOG NUMBER: PHILIPS F28T5/835/ALTO

BALLASTS: TWO ADVANCE ICN-2S28

MOUNTING: PENDANT

NOTE: THIS TEST WAS CALCULATED USING MEASURED DATA FROM LTL TEST NUMBERS 12729 AND 12722.
LUMEN TO CANDELA RATIO USED = 9.18
TOTAL INPUT WATTS = 82.2 AT 120.0 VOLTS
THE 0 DEGREE PLANE IS PARALLEL WITH THE LAMPS.

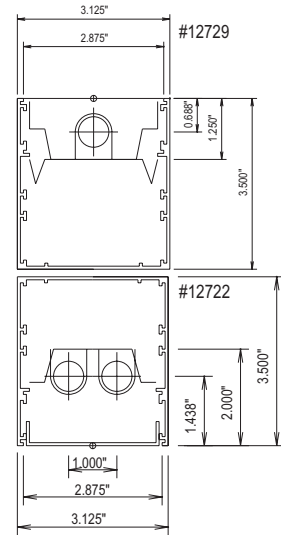

CANDELA DISTRIBUTION						FLUX
	0.0	22.5	45.0	67.5	90.0	
0	1137	1137	1137	1137	1137	
5	1131	1129	1133	1126	1129	107
15	1088	1081	1074	1060	1060	303
25	1003	987	964	922	907	440
35	874	844	762	694	678	480
45	699	631	538	492	478	433
55	473	401	333	283	265	311
65	222	216	171	146	140	179
75	78	94	93	88	85	94
85	13	27	32	30	29	30
90	0	2	4	6	6	
95	16	67	58	58	53	57
105	82	174	224	262	283	225
115	157	275	345	378	385	316
125	231	423	473	484	490	390
135	300	511	539	544	592	397
145	358	542	656	668	647	370
155	406	524	666	713	724	285
165	438	486	578	638	657	160
175	456	454	470	481	486	46
180	451	451	451	451	451	

ZONAL LUMEN SUMMARY			
ZONE	LUMENS	%LAMP	%FIXT
0- 30	850	10.9	18.4
0- 40	1330	17.0	28.8
0- 60	2074	26.5	44.9
0- 90	2378	30.4	51.4
90-120	598	7.6	12.9
90-130	988	12.6	21.4
90-150	1755	22.4	38.0
90-180	2246	28.7	48.6
0-180	4623	59.0	100.0

TOTAL LUMINAIRE EFFICIENCY: 59.0%
CIE TYPE: GENERAL DIFFUSE
PLANE: 0-DEG 90-DEG
SPACING CRITERIA: 1.2 1.1

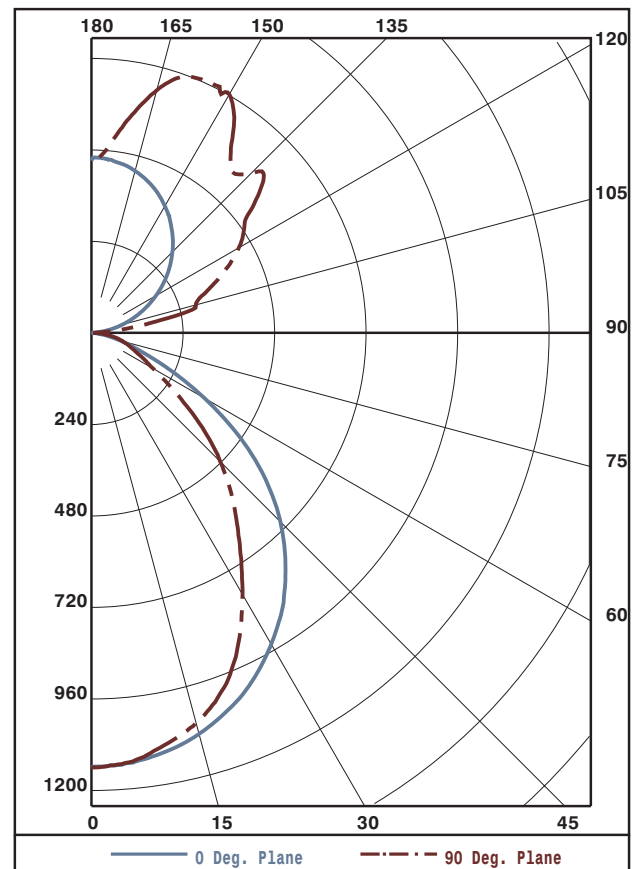

Approved By: MG

THIS REPORT BASED ON LM-41 AND OTHER PERTINENT IESNA PROCEDURES.



LTL NUMBER: 13043

DATE: 04-11-2008

PREPARED FOR: PRECISION ARCHITECTURAL LIGHTING

COEFFICIENTS OF UTILIZATION - ZONAL CAVITY METHOD
EFFECTIVE FLOOR CAVITY REFLECTANCE 0.20

Table with columns RC, RW, and rows for angles 80, 70, 50, 30, 10, 0. Values range from 28 to 63.

PLANE: 0-DEG 90-DEG
LUMINOUS LENGTH: 48.000 2.875

Table with columns ANGLE IN DEG, AVERAGE 0-DEG, AVERAGE 45-DEG, AVERAGE 90-DEG. Values range from 1675 to 12770.



LUMINAIRE TESTING LABORATORY, INC.

SUSTAINING MEMBER of the IESNA

905 Harrison Street · Allentown, PA 18103 · 610-770-1044 · Fax 610-770-8912 · www.LuminaireTesting.com

LTL NUMBER: 13043

DATE: 04-11-2008

PREPARED FOR: PRECISION ARCHITECTURAL LIGHTING

CANDELA DISTRIBUTION

Table with 6 columns of candela values for various angles from 0 to 180 degrees.

ZONAL LUMEN SUMMARY

Table with 2 columns showing lumen values for various angular zones from 0-5 to 175-180 degrees.

THIS TEST WAS CONDUCTED USING RELATIVE PHOTOMETRY TECHNIQUES ACCORDING TO STANDARD IESNA PROCEDURES. THE USER MUST THEREFORE USE CAUTION IN THE FOLLOWING SITUATIONS: 1) THIS TEST WAS PERFORMED USING A SPECIFIC BALLAST/LAMP COMBINATION. EXTRAPOLATION OF THESE DATA FOR OTHER BALLAST/LAMP COMBINATIONS MAY PRODUCE ERRONEOUS RESULTS. 2) ACCORDING TO IESNA PROCEDURES, THE BALLAST(S) AND LAMP(S) ARE PRESUMED TO PRODUCE 100% OF RATED OUTPUT. AN APPROPRIATE BALLAST FACTOR MUST BE APPLIED TO THE LUMEN OUTPUT RATINGS AND LUMINOUS INTENSITY VALUES GIVEN. 3) THIS TEST WAS CONDUCTED IN A CONTROLLED LABORATORY ENVIRONMENT WHERE THE AMBIENT TEMPERATURE WAS HELD AT 25°C ±1°C. FIELD PERFORMANCE MAY DIFFER PARTICULARLY IN REGARDS TO CHANGE IN LUMINOUS OUTPUT AS A RESULT OF DIFFERENCE IN AMBIENT TEMPERATURE AND METHOD OF MOUNTING THE LUMINAIRE.