



LTL NUMBER: 06525

DATE: 02-21-2002

PREPARED FOR: PRECISION ARCHITECTURAL LIGHTING

CATALOG NUMBER: LMSO4-PH-X-WR-4-120-T8

LUMINAIRE: EXTRUDED ALUMINUM HOUSING WITH FORMED STEEL ENDS, FORMED WHITE ENAMEL ALUMINUM REFLECTOR, PERFORATED SECTIONS WITH TRANSLUCENT WHITE ACRYLIC INSERTS, OPEN TOP.

LAMPS: FOUR PHILIPS F32T8/TL841 RATED AT 2850 LUMENS EACH.

BALLAST: ONE ADVANCE REL-4P32-SC

MOUNTING: PENDENT

LUMEN TO CANDELA RATIO USED = 9.18

TOTAL INPUT WATTS = 114.2 AT 120.0 VOLTS

THE 0 DEGREE PLANE IS PARALLEL WITH THE LAMPS.

#06525

CANDELA DISTRIBUTION

	0.0	22.5	45.0	67.5	90.0	FLUX
0	148	148	148	148	148	14
5	145	145	145	145	143	40
15	136	138	141	141	141	60
25	121	124	126	133	141	73
35	102	103	120	129	134	75
45	76	81	100	111	117	68
55	49	63	79	92	95	54
65	30	39	55	72	78	38
75	15	23	35	49	56	21
85	7	11	18	28	34	27
90	0	8	16	23	27	232
95	96	210	225	231	234	773
105	523	699	760	799	816	1229
115	991	1160	1309	1337	1344	1515
125	1431	1580	1721	1831	1858	1574
135	1819	1944	2067	2147	2179	1446
145	2138	2227	2333	2391	2417	1154
155	2390	2435	2522	2559	2577	739
165	2562	2580	2620	2644	2656	253
175	2652	2653	2664	2657	2658	
180	2662	2662	2662	2662	2662	

FLUX

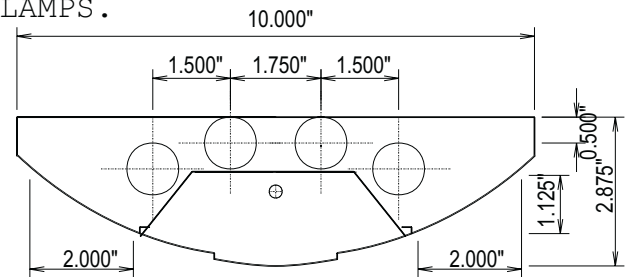

ZONAL LUMEN SUMMARY

ZONE	LUMENS	%LAMP	%FIXT
0- 30	113	1.0	1.2
0- 40	186	1.6	2.0
0- 60	329	2.9	3.5
0- 90	442	3.9	4.7
90-120	2234	19.6	23.9
90-130	3749	32.9	40.1
90-150	6768	59.4	72.3
90-180	8915	78.2	95.3
0-180	9356	82.1	100.0

TOTAL LUMINAIRE EFFICIENCY: 82.1%
 TOTAL REFLECTANCE OF PAINT: 91.3%
 CIE TYPE: INDIRECT
 PLANE: 0-DEG 90-DEG
 SPACING CRITERIA: 1.1 1.4

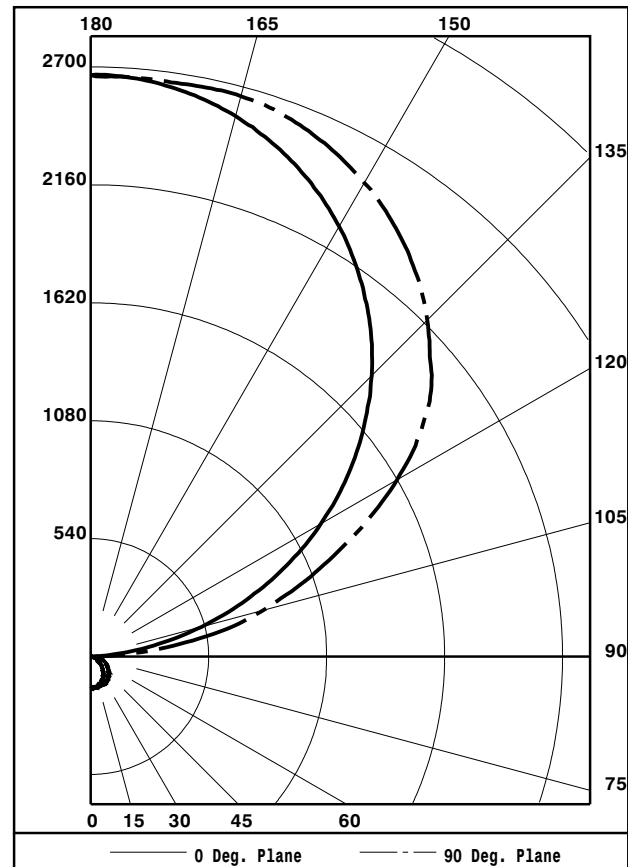

TESTED BY HERSCHEL SCHRECK
 CHECKED BY MIKE GRATHER



LUMINAIRE TESTING LABORATORY, INC.



905 Harrison Street · Allentown, PA 18103 · (610) 770-1044 · Fax (610) 770-8912 · www.LuminaireTesting.com

LTL NUMBER: 06525

DATE: 02-21-2002

PREPARED FOR: PRECISION ARCHITECTURAL LIGHTING

COEFFICIENTS OF UTILIZATION - ZONAL CAVITY METHOD
EFFECTIVE FLOOR CAVITY REFLECTANCE 0.20

Table with columns RC, RW, and rows for angles 80, 70, 50, 30, 10, 0. Each cell contains a numerical value representing the coefficient of utilization.

PLANE: 0-DEG 90-DEG
LUMINOUS LENGTH: 46.500 4.000
HEIGHT OF SIDE: 0.000 1.125

Table with columns ANGLE IN DEG, AVERAGE, and rows for angles 0, 45, 55, 65, 75, 85. Each cell contains a numerical value representing luminance in candela per square meter.



LTL NUMBER: 06525

DATE: 02-21-2002

PREPARED FOR: PRECISION ARCHITECTURAL LIGHTING

CANDELA DISTRIBUTION

ZONAL LUMEN SUMMARY

Table with 6 columns: Candela values at 0.0, 22.5, 45.0, 67.5, 90.0 degrees and Zonal Lumen Summary ranges from 0-5 to 175-180.

THIS TEST WAS CONDUCTED USING RELATIVE PHOTOMETRY TECHNIQUES ACCORDING TO STANDARD IESNA PROCEDURES. THE USER MUST THEREFORE USE CAUTION IN THE FOLLOWING SITUATIONS: 1) THIS TEST WAS PERFORMED USING A SPECIFIC BALLAST/LAMP COMBINATION. EXTRAPOLATION OF THESE DATA FOR OTHER BALLAST/LAMP COMBINATIONS MAY PRODUCE ERRONEOUS RESULTS. 2) ACCORDING TO IESNA PROCEDURES, THE BALLAST(S) AND LAMP(S) ARE PRESUMED TO PRODUCE 100% OF RATED OUTPUT. AN APPROPRIATE BALLAST FACTOR MUST BE APPLIED TO THE LUMEN OUTPUT RATINGS AND LUMINOUS INTENSITY VALUES GIVEN. 3) THIS TEST WAS CONDUCTED IN A CONTROLLED LABORATORY ENVIRONMENT WHERE THE AMBIENT TEMPERATURE WAS HELD AT 25°C ±1°C. FIELD PERFORMANCE MAY DIFFER PARTICULARLY IN REGARDS TO CHANGE IN LUMINOUS OUTPUT AS A RESULT OF DIFFERENCE IN AMBIENT TEMPERATURE AND METHOD OF MOUNTING THE LUMINAIRE.



LUMINAIRE TESTING LABORATORY, INC.



905 Harrison Street · Allentown, PA 18103 · (610) 770-1044 · Fax (610) 770-8912 · www.LuminaireTesting.com

INITIAL ILLUMINATION OF 50 FOOTCANDLES USING LTL TEST NUMBER 06525
LUMINAIRE SUSPENSION LENGTH = 1.5
WORKING PLANE HEIGHT = 2.50
FLOOR REFLECTANCE = 20

Table with columns for ROOM HT, CEIL RF, WALL RF, WIDTH, LENGTH, and 16 columns of footcandle values for different room dimensions and reflectance levels.

QUANTITY OF LUMINAIRES