



LTL NUMBER: 06550

DATE: 03-20-2002

PREPARED FOR: PRECISION ARCHITECTURAL LIGHTING

CATALOG NUMBER: LMSO2-SH-X-WR-4-X-X-120-T8

LUMINAIRE: EXTRUDED ALUMINUM HOUSING WITH FORMED STEEL ENDS, FORMED WHITE ENAMEL ALUMINUM REFLECTORS, OPEN TOP.

LAMPS: TWO PHILIPS F32T8/TL841 RATED AT 2850 LUMENS EACH.

BALLAST: ONE ADVANCE REL-2P32-SC

MOUNTING: PENDENT

LUMEN TO CANDELA RATIO USED = 9.18

TOTAL INPUT WATTS = 59.5 AT 120.0 VOLTS

THE 0 DEGREE PLANE IS PARALLEL WITH THE LAMPS.

#06550

CANDELA DISTRIBUTION					
	0.0	22.5	45.0	67.5	90.0
90	0	5	6	6	6
95	52	172	198	204	204
105	265	433	602	683	686
115	492	637	803	905	943
125	708	809	971	1070	1105
135	895	972	1095	1185	1215
145	1050	1101	1183	1247	1274
155	1168	1195	1250	1284	1297
165	1253	1262	1287	1301	1307
175	1297	1295	1306	1302	1300
180	1300	1300	1300	1300	1300

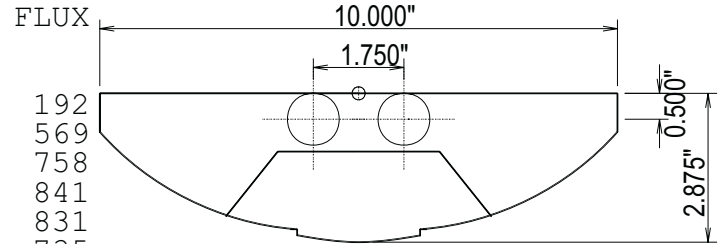

ZONAL LUMEN SUMMARY

ZONE	LUMENS	%LAMP	%FIXT
0- 90	0	0.0	0.0
90-120	1519	26.6	30.5
90-130	2360	41.4	47.3
90-150	3927	68.9	78.7
90-180	4987	87.5	100.0
0-180	4987	87.5	100.0

TOTAL LUMINAIRE EFFICIENCY: 87.5%
 TOTAL REFLECTANCE OF PAINT: 91.2%
 CIE TYPE: INDIRECT

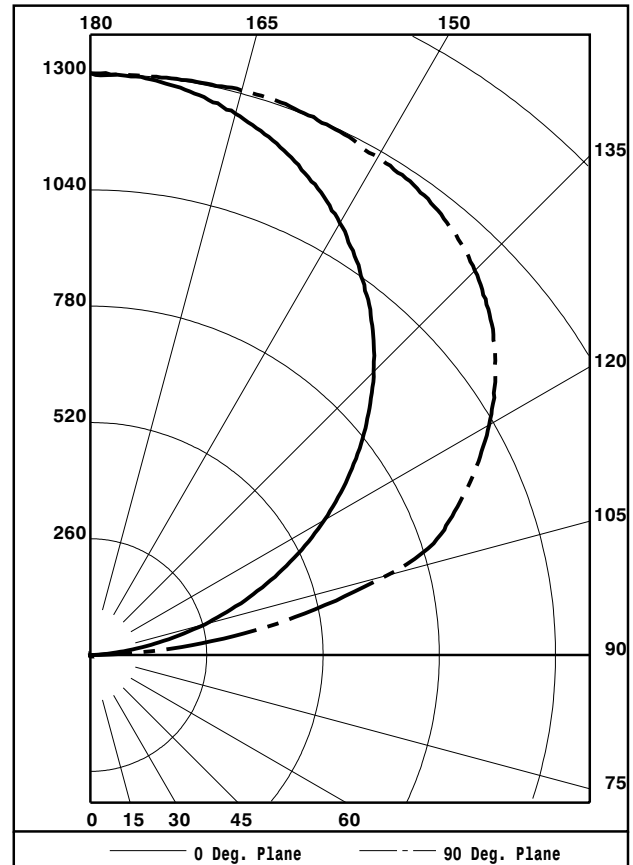

TESTED BY HERSCHEL SCHRECK
 CHECKED BY MIKE GRATHER



LTL NUMBER: 06550

DATE: 03-20-2002

PREPARED FOR: PRECISION ARCHITECTURAL LIGHTING

COEFFICIENTS OF UTILIZATION - ZONAL CAVITY METHOD
EFFECTIVE FLOOR CAVITY REFLECTANCE 0.20

Table with columns RC, RW, and rows for cavity heights 80, 70, 50, 30, 10, 0. Each row contains 18 numerical values representing utilization coefficients.

CANDELA DISTRIBUTION

Table with columns for candela values (0.0, 22.5, 45.0, 67.5, 90.0) and rows for beam angles (90, 95, 100, 105, 110, 115, 120, 125, 130, 135, 140, 145, 150, 155, 160, 165, 170, 175, 180).

ZONAL LUMEN SUMMARY

Table with columns for zonal lumen ranges (90-95, 95-100, 100-105, 105-110, 110-115, 115-120, 120-125, 125-130, 130-135, 135-140, 140-145, 145-150, 150-155, 155-160, 160-165, 165-170, 170-175, 175-180) and corresponding lumen values.

THIS TEST WAS CONDUCTED USING RELATIVE PHOTOMETRY TECHNIQUES ACCORDING TO STANDARD IESNA PROCEDURES. THE USER MUST THEREFORE USE CAUTION IN THE FOLLOWING SITUATIONS: 1) THIS TEST WAS PERFORMED USING A SPECIFIC BALLAST/LAMP COMBINATION. EXTRAPOLATION OF THESE DATA FOR OTHER BALLAST/LAMP COMBINATIONS MAY PRODUCE ERRONEOUS RESULTS. 2) ACCORDING TO IESNA PROCEDURES, THE BALLAST(S) AND LAMP(S) ARE PRESUMED TO PRODUCE 100% OF RATED OUTPUT. AN APPROPRIATE BALLAST FACTOR MUST BE APPLIED TO THE LUMEN OUTPUT RATINGS AND LUMINOUS INTENSITY VALUES GIVEN. 3) THIS TEST WAS CONDUCTED IN A CONTROLLED LABORATORY ENVIRONMENT WHERE THE AMBIENT TEMPERATURE WAS HELD AT 25°C ±1°C. FIELD PERFORMANCE MAY DIFFER PARTICULARLY IN REGARDS TO CHANGE IN LUMINOUS OUTPUT AS A RESULT OF DIFFERENCE IN AMBIENT TEMPERATURE AND METHOD OF MOUNTING THE LUMINAIRE.



LUMINAIRE TESTING LABORATORY, INC.



905 Harrison Street · Allentown, PA 18103 · (610) 770-1044 · Fax (610) 770-8912 · www.LuminaireTesting.com

INITIAL ILLUMINATION OF 50 FOOTCANDLES USING LTL TEST NUMBER 06550
 LUMINAIRE SUSPENSION LENGTH = 1.5
 WORKING PLANE HEIGHT = 2.50
 FLOOR REFLECTANCE = 20

ROOM HT	CEIL RF	8				9				10				12			
		80	70	80	70	80	70	80	70	80	70	80	70	80	70		
WALL RF	RF	70	50	50	30	70	50	50	30	70	50	50	30	70	50	50	30
WIDTH	LENGTH																
10.	10.	2	2	3	3	2	3	3	3	2	3	3	4	3	3	4	5
10.	15.	3	3	3	4	3	3	4	4	3	4	4	5	3	4	5	6
15.	20.	4	5	6	6	5	5	6	7	5	6	6	7	5	6	7	8
15.	30.	6	7	8	8	6	7	8	9	7	8	9	10	7	9	10	11
20.	20.	6	6	7	8	6	6	7	8	6	7	8	9	7	8	9	10
20.	30.	8	8	10	10	8	9	10	11	8	9	11	12	9	10	12	13
20.	40.	10	11	13	13	11	11	13	14	11	12	14	15	12	13	15	17
20.	60.	15	16	18	19	15	16	19	20	16	17	20	22	17	19	22	24
30.	30.	11	12	14	15	12	12	14	15	12	13	15	16	13	14	16	18
30.	40.	15	15	18	19	15	16	19	20	15	17	19	21	16	18	21	23
30.	50.	18	19	22	23	18	20	23	24	19	20	24	25	20	22	25	27
30.	60.	21	22	26	27	22	23	27	28	22	24	28	29	23	26	30	32
60.	60.	41	42	49	50	42	43	50	52	42	44	52	54	43	46	54	57
60.	80.	54	55	65	66	55	56	66	68	55	58	67	70	57	60	70	73
60.	100.	67	69	80	82	68	70	82	84	69	71	83	86	70	74	86	90
100.	100.	110	112	131	133	111	113	132	135	112	115	134	137	114	118	138	143

QUANTITY OF LUMINAIRES