

# Latera Series™

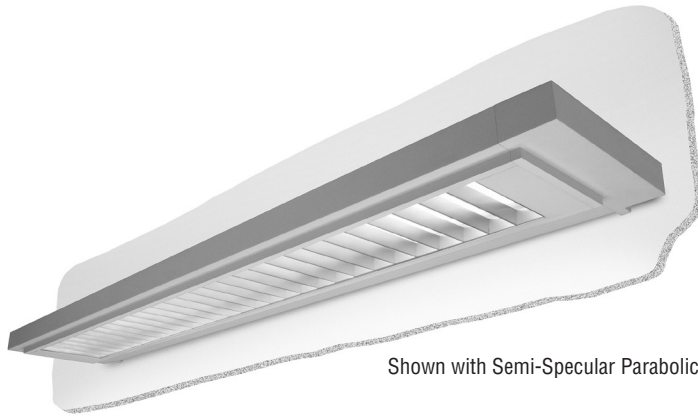

Shown with Semi-Specular Parabolic Baffle

Catalog Number	Type
Project Name	

## LTP01

### 9 7/8" x 2 1/8" Wall Mount Indirect/Direct (T8 Lamps)

#### S P E C I F I C A T I O N S

##### Housing

Two-piece .080" thick extruded aluminum. Die-cast aluminum end caps are secured with no visible fasteners. Standard lengths are 4' and 8'. Provisions may be made for continuous rows of any length.

##### Finish

Standard and premium finishes are baked powder coat electrostatically applied (2.0 mil minimum thickness) to assure aesthetics and durability.

##### End Caps

- (SE) Sculpted End - .100" thick die-cast aluminum finished to match fixture housing

##### Indirect Optical Controls

- (OP) Open Top
- (DC) Clear 100% Acrylic Dust Cover

##### Direct Optical Controls

- (PB) 3/4" deep semi-specular aluminum parabolic baffle with blades on 1 1/2" centers
- (PBW) 3/4" deep white aluminum parabolic baffle with blades on 1 1/2" centers

- (MPL) .115" thick acrylic compression molded micro-prismatic lens

##### Reflectors

Die-formed from .020" thick high reflectance specular aluminum.

##### Ballast

Standard ballasts for T8 lamps are UL/CUL listed, Class P, HPF, electronic, universal 120/277volt, instant start with <10% THD.

##### Circuitry

All fixtures are factory pre-wired for a single circuit. Provision for multiple switching/circuiting is optional.

##### Wiring

All fixtures intended for continuous rows are provided with factory installed quick-connect wiring.

##### Controls

Contact factory for control with Occupancy and/or Daylight Harvesting sensors.

##### Certification

All fixtures are UL/CUL listed for use in 'Dry Applications'. 'Damp Location' is optional.

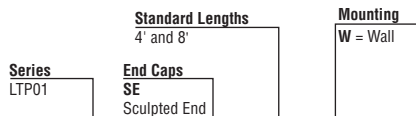
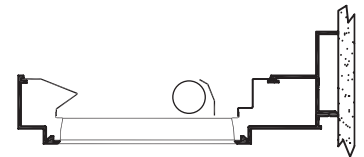

## LTP01-SE-8-W-OP/PB-F01M-V-T8-[ ]

##### Indirect Optical Controls

- OP**  
Open Top
- DC**  
Dust Cover

##### Direct Optical Controls

- PB**  
Parabolic Baffle
- PBW**  
White Parabolic Baffle
- MPL**  
Micro-Prismatic Lens

##### Standard Finish

F01M Matte White

##### Premium Finishes

- F01G** Gloss White
- F02** Ivory
- F03** Stonewash
- F04** Camel
- F05** Gray Day
- F06** Pebble Beach
- F07** Steel
- F08** Gray Seal
- F09** Mocha
- F10** Bronzed
- F11** Black
- F12** Ultrasonic Clear
- F13** Merlot
- F14** Red Skies
- F15** Lemon
- F16** Forest Hunter
- F17** Olive
- F18** Khaki
- F19** Heather Green
- F20** Blue Print
- F21** Reflex Blue
- F22** Navy
- FCC** Custom Color

##### Voltage

- 120
- 277
- 347

##### Lamp Type

T8

##### Options

- NLCKT**  
Separate Night Light Circuit
- EMCKT**  
Separate Emergency Circuit
- EBPL**  
Emergency Battery Pack (635-700 Lumens)
- EBPH**  
Emergency Battery Pack (975-1325 Lumens)
- DL**  
Damp Location
- Dim**  
Dimming
- FS**  
Fused Ballasts
- GTD**  
Generator Transfer Device
- AO**  
Translucent White Acrylic Overlay above Baffle
- DS**  
Integral Mount Daylight Sensor
- OS**  
Integral Mount Occupancy Sensor



# LTP01

## Wall Mount Indirect/Direct - T8 Lamps

### LTP01-W-MPL-T8

#### Open Up/Micro-Prismatic Lens Down

**Catalog Number:** LTP01-SE-4-W-MPL-F01M-120-T8

**Report Number:** ITL#70217.ies

**Luminaire Description:** Extruded Aluminum Housing with  
Specular Aluminum Reflector and  
Micro-Prismatic Acrylic Lens  
Open Top

**Lamp:** One Sylvania F032T8/835  
Rated at 2950 Lumens

Total Luminaire Efficiency = 84.9%

62% Up 38% Down

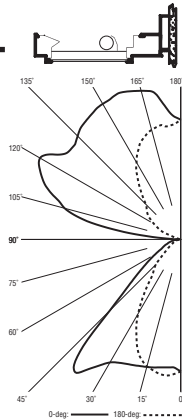

Visit [www.pal-lighting.com](http://www.pal-lighting.com) for complete photometric reports.



Precision Architectural Lighting 4830 Timber Creek Drive Houston, Texas 77017  
Tel 713.946.4343 Fax 713.946.4441 [www.pal-lighting.com](http://www.pal-lighting.com)