

Latera Series™

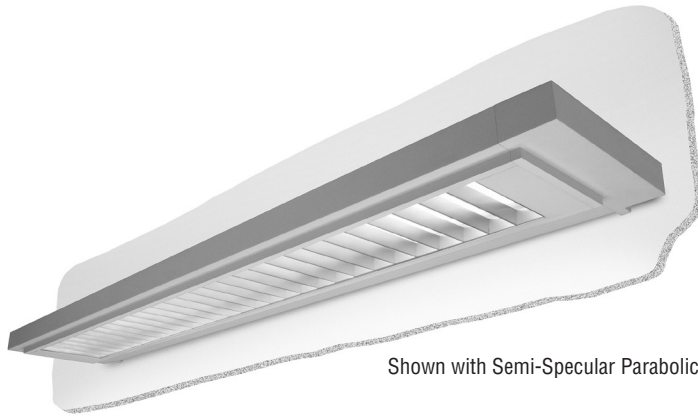

Shown with Semi-Specular Parabolic Baffle

Catalog Number	Type
Project Name	

LTP01

9 7/8" x 2 1/8" Wall Mount
Indirect/Direct
(T5 or T5HO Lamps)

S P E C I F I C A T I O N S

Housing

Two-piece .080" thick extruded aluminum. Die-cast aluminum end caps are secured with no visible fasteners. Standard lengths are 4' and 8'. Provisions may be made for continuous rows of any length.

Finish

Standard and premium finishes are baked powder coat electrostatically applied (2.0 mil minimum thickness) to assure aesthetics and durability.

End Caps

- (SE) Sculpted End - .100" thick die-cast aluminum finished to match fixture housing

Indirect Optical Controls

- (OP) Open Top
- (DC) Clear 100% Acrylic Dust Cover

Direct Optical Controls

- (PB) 3/4" deep semi-specular aluminum parabolic baffle with blades on 1 1/2" centers
- (PBW) 3/4" deep white aluminum parabolic baffle with blades on 1 1/2" centers

- (MPL) .115" thick acrylic compression molded micro-prismatic lens

Reflectors

Die-formed from .020" thick high reflectance specular aluminum.

Ballast

Standard ballasts for T5 and T5HO lamps are UL/CUL listed, Class P, HPF, electronic, universal 120/277volt, programmed rapid start with <10% THD.

Circuitry

All fixtures are factory pre-wired for a single circuit. Provision for multiple switching/circuiting is optional.

Wiring

All fixtures intended for continuous rows are provided with factory installed quick-connect wiring.

Controls

Contact factory for control with Occupancy and/or Daylight Harvesting sensors.

Certification

All fixtures are UL/CUL listed for use in 'Dry Applications'. 'Damp Location' is optional.

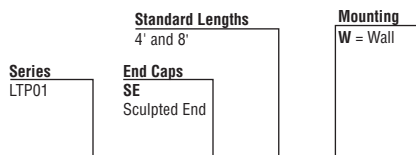
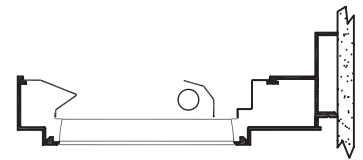

LTP01-SE-8-W-OP/PB-F01M-V-T5-[]

Indirect Optical Controls	Direct Optical Controls	Standard Finish	Voltage	Lamp Type	Options
OP Open Top	PB Parabolic Baffle	F01M Matte White	120	T5	NLCKT Separate Night Light Circuit
DC Dust Cover	PBW White Parabolic Baffle	Premium Finishes	277	T5HO	EMCKT Separate Emergency Circuit
	MPL Micro-Prismatic Lens	F01G Gloss White	347		EBPL Emergency Battery Pack (635-700 Lumens)
		F02 Ivory			EBPH Emergency Battery Pack (975-1325 Lumens)
		F03 Stonewash			DL Damp Location
		F04 Camel			Dim Dimming
		F05 Gray Day			FS Fused Ballasts
		F06 Pebble Beach			GTD Generator Transfer Device
		F07 Steel			AO Translucent White Acrylic Overlay above Baffle
		F08 Gray Seal			DS Integral Mount Daylight Sensor
		F09 Mocha			OS Integral Mount Occupancy Sensor
		F10 Bronzed			
		F11 Black			
		F12 Ultrasonic Clear			
		F13 Merlot			
		F14 Red Skies			
		F15 Lemon			
		F16 Forest Hunter			
		F17 Olive			
		F18 Khaki			
		F19 Heather Green			
		F20 Blue Print			
		F21 Reflex Blue			
		F22 Navy			
		FCC Custom Color			



LTP01

Wall Mount Indirect/Direct - T5 and T5H0 Lamps

LTP01-W-MPL-T5

Open Top/Micro-Prismatic Lens Down

Catalog Number: LTP01-SE-4-W-OP/MPL-F01M-120-T5

Report Number: ITL#70220.ies

Luminaire Description: Extruded Aluminum Housing with
Specular Aluminum Reflector and
Micro-Prismatic Acrylic Lens
Open Top

Lamp: One Sylvania FP28T5/841/ECO
Rated at 2600 Lumens

Total Luminaire Efficiency = 84.0%

51% Up 49% Down

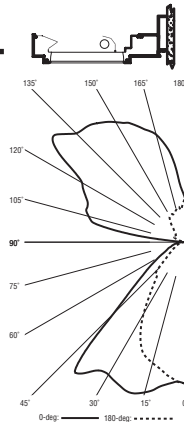

Visit www.pal-lighting.com for complete photometric reports.

